

Installation Instructions

Regal Series



Recessed Flatwall
Back to Back

Before Installation

NOTE: Flatwall installation should conform to local building codes

The installation instructions provided is for the Amico standard products. Slight modifications to the installations may be required. The product shipped to the job site may not be exactly as shown on the installation drawings.

1. Review a copy of the final approved shop drawing(s) and/or submittal package. These documents will provide you with technical information specific to your installation, such as:
 - equipment types and quantities
 - room numbers and location
 - shop drawings of each unit type
 - wiring diagrams and rough-in locations
2. Locate the flatwall unit from the shipping boxes that you wish to install. The contents of each shipping box are listed on the shipping document(s).
3. Ensure that studs are located according to **Figure 1** or **Figure 2**, depending on the width of the flatwall.

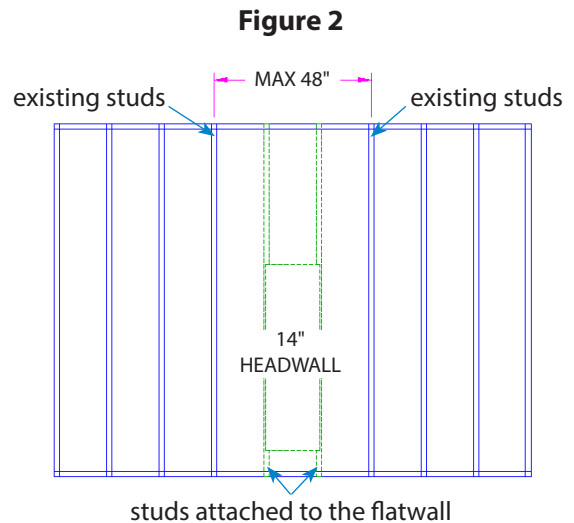
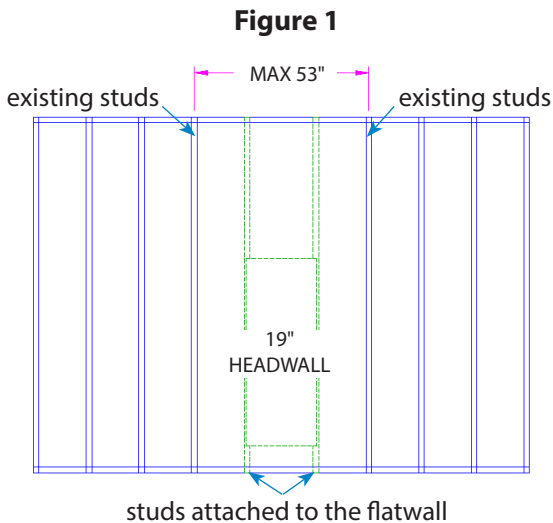

4. Ensure that the drywall thickness is in accordance with the as-built drawings. This drawing shows a drywall thickness of 5/8" and is for reference only.

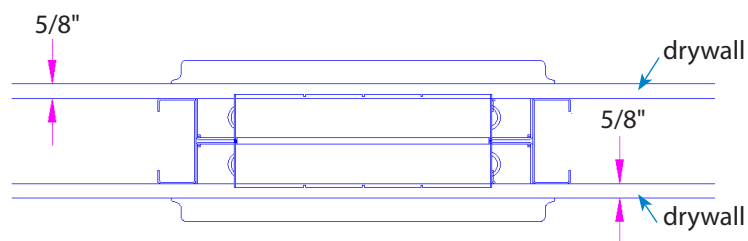

Installation

1. Secure flatwall to building structure using hardware (by others) compliant to applicable building codes. Ensure mounting location corresponds to on-site location of rough-ins. Fastening of studs to tracks by others.

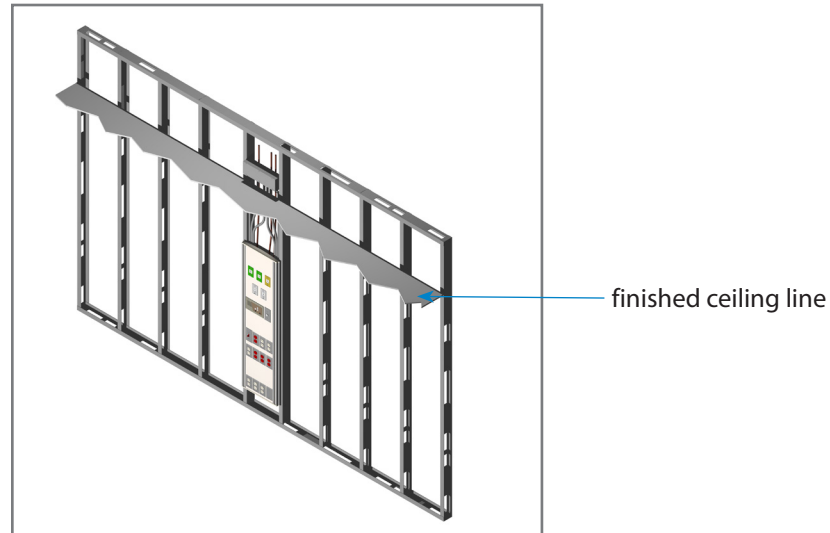

2. Make all electrical and piping connections. Med gas piping is terminated as per shop drawings; electrical services are terminated at boxes attached to upper framing in flatwall structure.

NOTE: Remove all zip ties where applicable

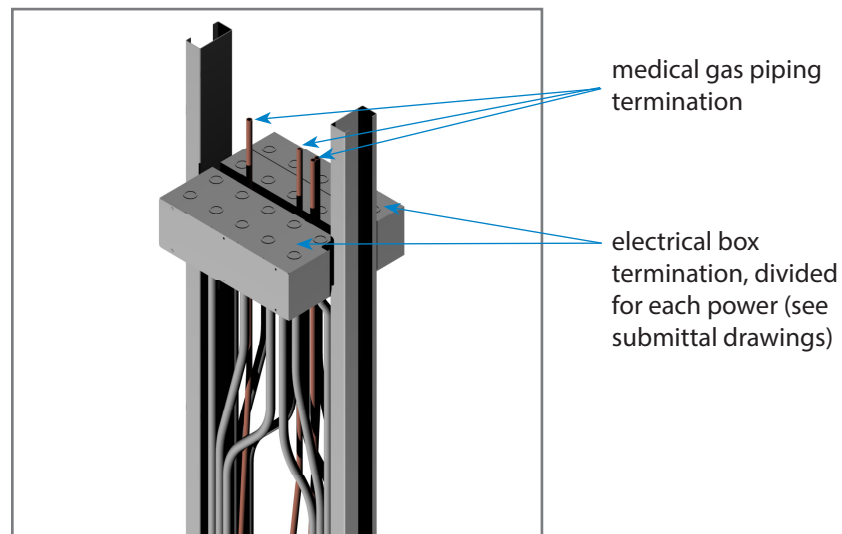

3. Install drywall. See following section for instructions. Note that the unit is shipped with a gap allowed between the flatwall front lip and stud face; this is to allow clearance for drywall installation.

Installation

NOTE: Store all parts removed from the headwall in a safe and clean location, to be reattached after drywall has been installed.

1. Remove the 2 plastic snap-on end caps.

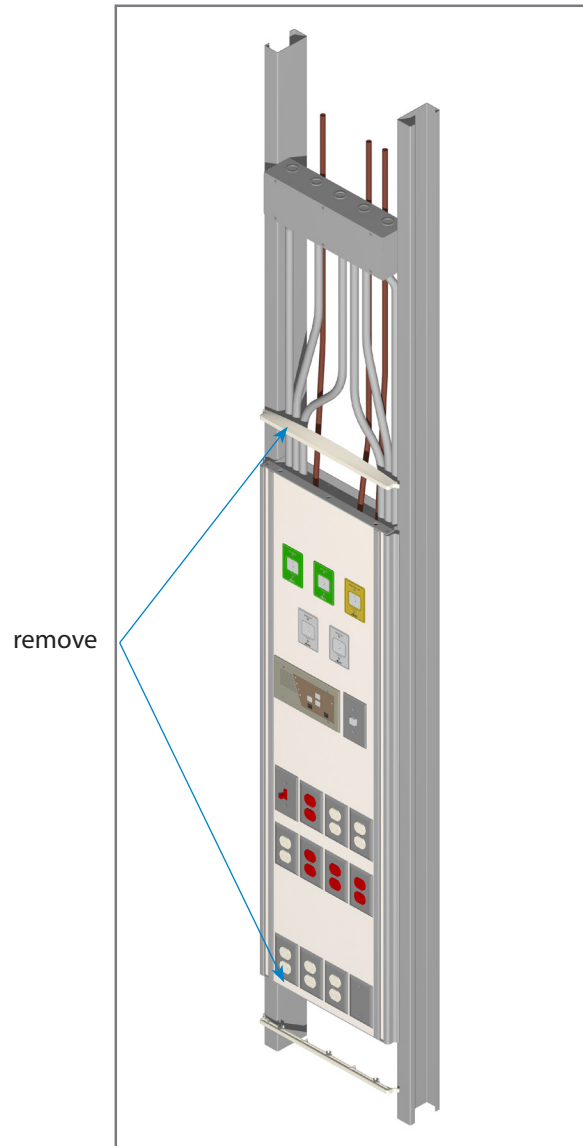

Installation

2. Install and finish drywall, including taping and painting. Drywall goes under the rails.

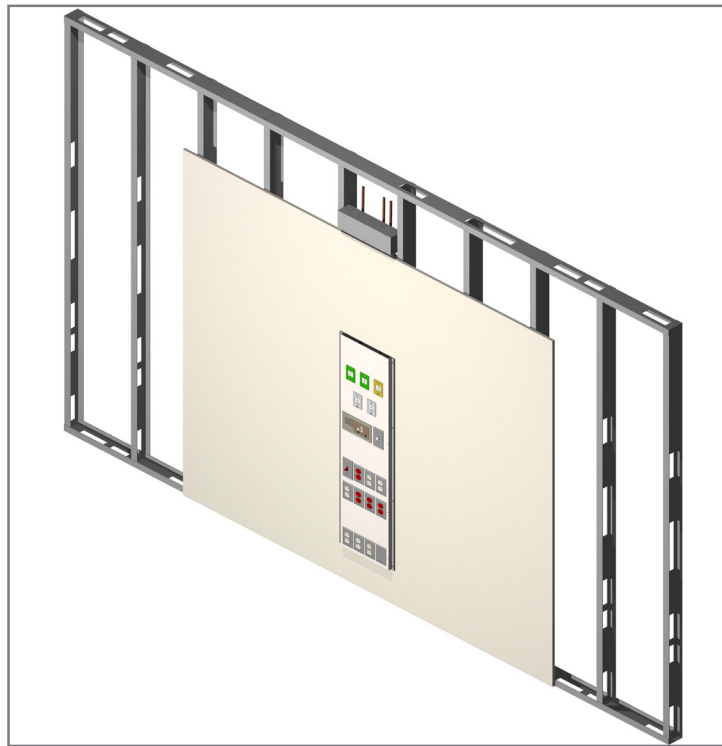

NOTES:

1. Division 15 to connect gas stubs on flatwall to building medical gas supply lines previously roughed in.
2. Division 16 to do all electrical connections required.
3. Amico does not recommend removing the Vertical rails. If you need to do so , please see important notes below :
 - Note the CAUTION label located inside the Vertical rails

CAUTION: CORRECT SCREWS MUST BE USED TO ATTACH RAIL (SEE INSTALLATION INSTRUCTIONS)

- Note screw color/type installed into the unit is #8x1" Flat Head Quadrex–Self Drill Screw, yellow zinc plated

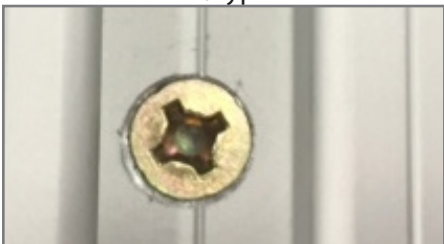

- You must use the same screws when attaching the rails back to the headwall structure. Do not use any alternative hardware

www.amico.com

Amico Corporation | 85 Fulton Way, Richmond Hill, ON L4B 2N4, Canada
600 Prime Place, Hauppauge, NY 11788, USA
Toll Free Tel: 1.877.462.6426 | Tel: 905.764.0800 | Fax: 905.764.0862
Email: info@amico.com | www.amico.com

